



# INSTRUCTIONS AND TEMPLATE FOR CL600 PK PANIC KIT MECHANICAL LOCK



## CL600 Mechanical Lock Trim

Using the template on page 2, install the CL600 Lock Trim with the Exit Device. Tape template to the door, mark the holes and drill where needed.

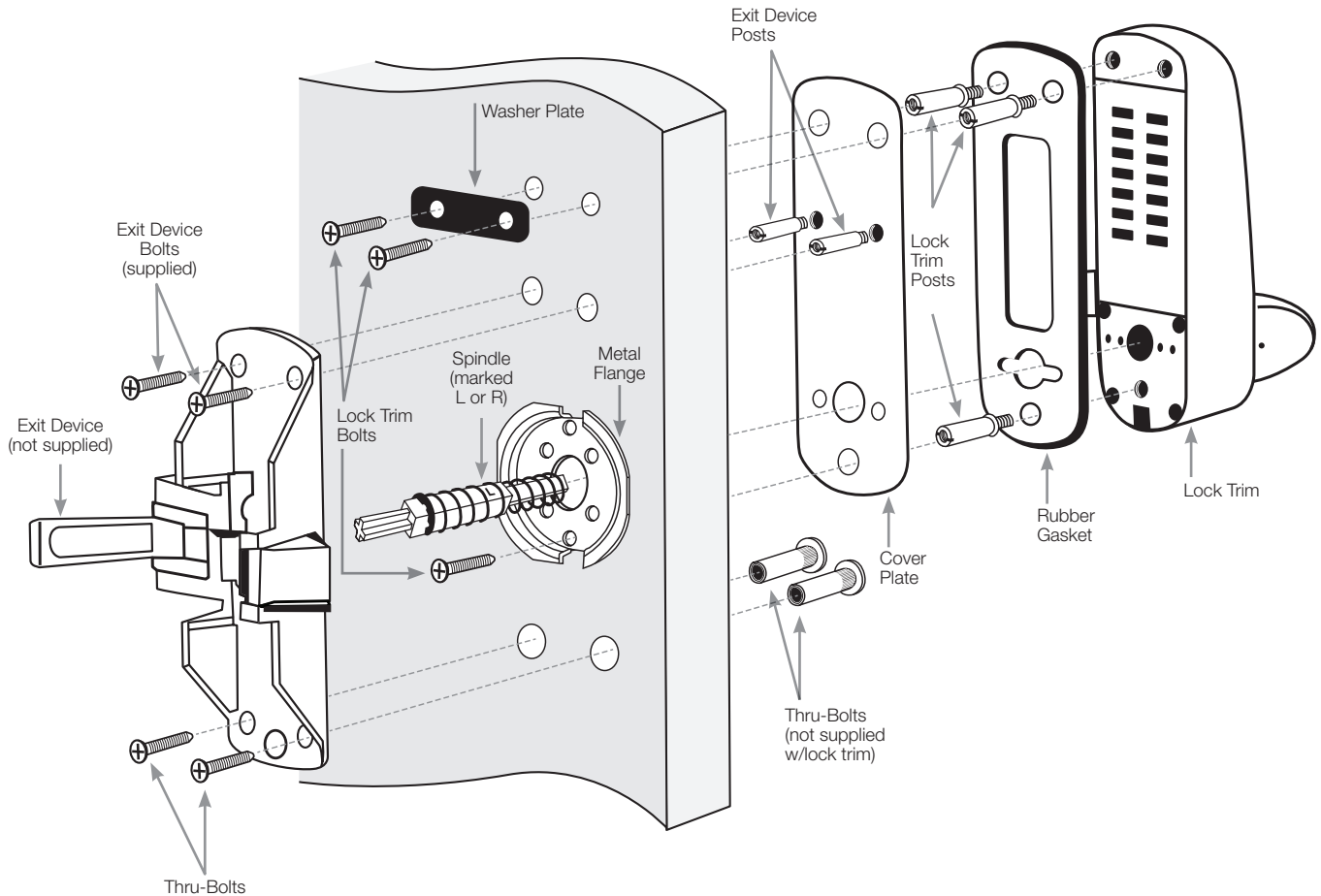

1. Fit Rubber gasket onto the back of Lock Trim .
2. Screw 3 Lock Trim Posts into back of Lock Trim and tighten.
3. Screw 2 Exit Device Posts to the Cover Plate plate and tighten.
4. Fit Cover Plate over the 3 Lock Trim Posts .
5. Attach the Lock Trim to the door using the 2 Bolts and Washer Plate on top and 1 Bolt and Metal Flange through the 2-1/8" door prep.  
*(If no door prep, follow template instruction to drill proper holes)*
6. Using the correct Spindle, marked L for left hand or R for right hand, fit the spindle set through the door and insert it to the spindle hole on the Lock Trim.
7. Hold panic device to the door, aligning holes and spindle. Secure to Lock Trim Thru-bolts.
8. Attach the panic device – sold separately.

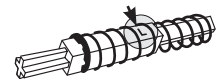
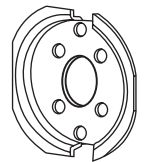

## CL600 Mechanical Lock Trim

1. Align template center-line (CL) with the CL of the Exit Device (as illustrated). Tape template to the door, mark the holes and drill where needed.

**Template  
Actual Size**

**1" Square**

Print PDF at 100%  
Actual Size

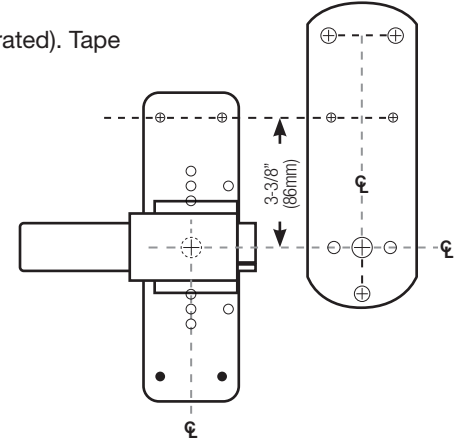
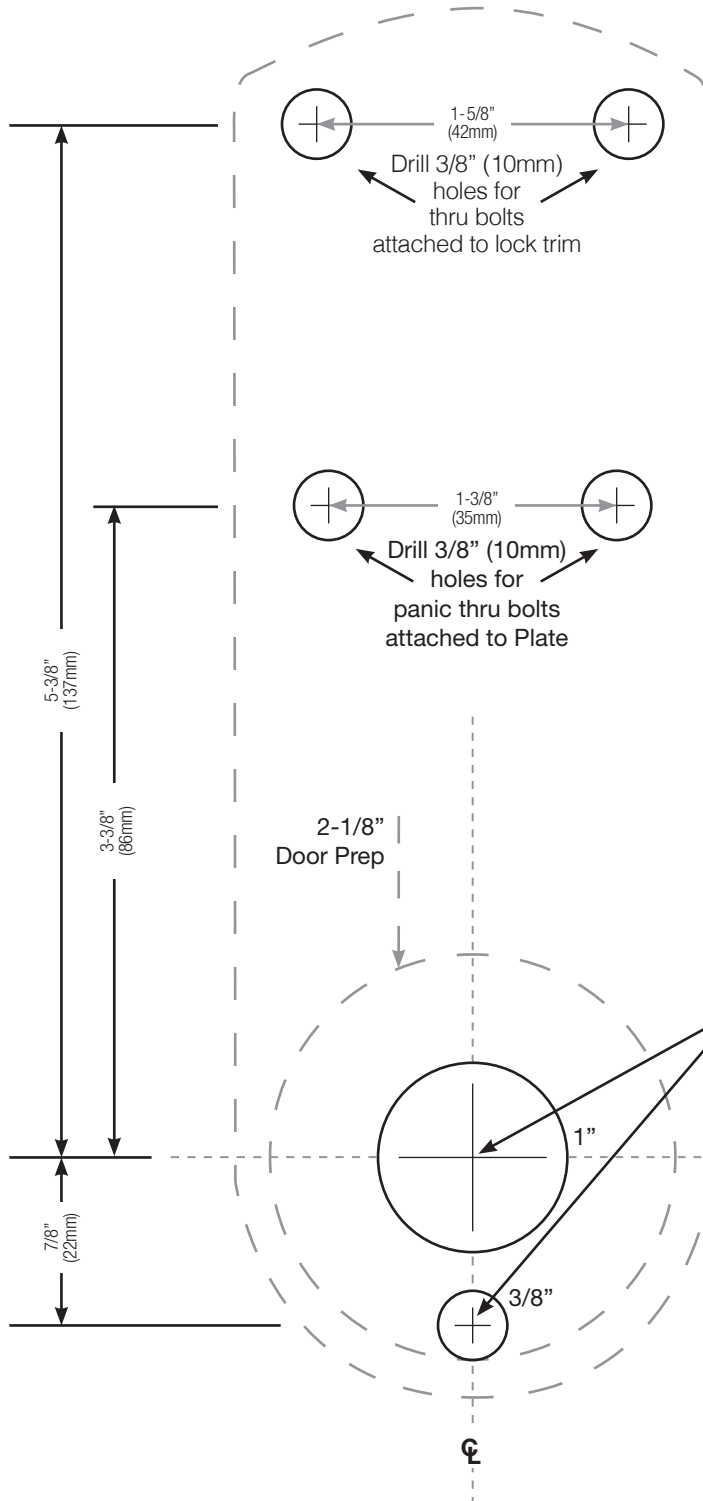

Use metal flange to cover 2-1/8" door prep, to attach bottom of lock trim.

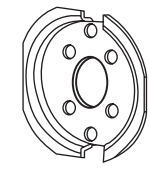

If there is no 2-1/8" Door Prep, drill the following 1" dia. and 3/8" dia. holes.